

## PW Series Pneumatic Torque Wrench

— Pneumatic torque wrenches were widely used on automotive vehicles, petrochemicals, shipbuilding, electric power, aerospace, construction and other fields.

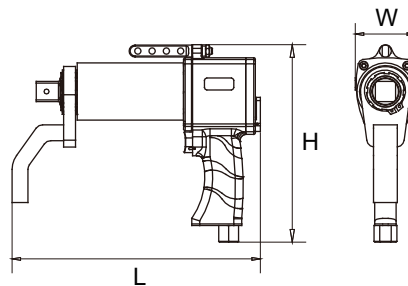

- Accuracy:  $\pm 5\%$
- For high torque and continuous work applications.
- Aluminum alloy handle, relatively light weight.
- Reaction arm, gear box and body can be flexibly connected to reach desired reaction point.
- Work in Clockwise and Counter-clockwise directions.
- Can be used with standard impact sockets.



**PW** Model

Item No.	Output Square Drive	Gear box Diameter	Dimensions LxWxH mm	Torque Range N.m	Weight kg	Max. Pressure
PWA14350	3/4"	$\phi 50$	259x65x250	70-350	3.1	6bar
PWA24800	3/4"	$\phi 59$	272x75x252	160-800	4.3	6bar
PWT241000	3/4"	$\phi 72$	283x75x252	200-1000	5.7	6bar
PWT251000	1"	$\phi 72$	283x75x252	200-1000	5.7	6bar
PWH352000	1"	$\phi 92 - \phi 59$	370x100x267	400-2000	8.8	6bar
PWN352500	1"	$\phi 92 - \phi 59$	370x100x267	500-2500	9.3	6bar
PWD354000	1"	$\phi 108 - \phi 59$	400x108x270	800-4000	12	6bar
PWD365000	1 1/2"	$\phi 108 - \phi 59$	400x108x270	1000-5000	12	6bar
PWD366000	1 1/2"	$\phi 126 - \phi 59$	488x100x264	1200-6000	16	6bar

Please contact distributor for Impact Sockets. >>>

