

1" Air Impacttools™ / Rear Handle

6315 – standard anvil

631L – 200 mm anvil

- 4 300 Nm (3 170 ft-lb).
- Pinless single swinging-hammer impact mechanism.
- 4-position power regulator.
- Allen key & 1/2" air inlet connector.
- Hole-through anvil.



4300 Nm!

631LSK-packed with:

- 2 pcs 41mm hex socket (90mm long) &
- 2 pcs 21 mm female square budd wheel socket (60mm long)



280 - Short anvil

280-6 - 150 mm anvil

280-S-6-#5 Spline Drive, 150mm anvil

- 2 169 Nm (1 600 ft-lb).
- Jumbo-hammer impact mechanism.
- Hole-through anvil.



285B-S6 - #5 Spline Drive, 150mm anvil

285B - Short anvil

285B-6 - 150 mm anvil, inside trigger, straight air inlet.

285B-6-AP - Outside trigger, 45 degree air inlet bushing

- Designed for operation at 8.3 bar.
- 2 400 Nm (1 700 ft-lb) at 8.3 bar.
- Pinless single swinging-hammer impact mechanism.
- 3-position power regulator.
- Ring & hole-through anvil.

2190Ti - Short anvil, ergonomic chainsaw-type handle

2190Ti-6 - 150 mm anvil, ergonomic chainsaw-type handle

2190DTi-6 - 150 mm anvil, rear handle

- 2 237 Nm (1 650 ft-lb).
- Only 6.13 kg (2190Ti).
- Twin-hammer impact mechanism.
- Titanium hammer case.
- 3-position power regulator.
- Ring & hole-through anvil.

Accessories: **2190-BOOT** (CPN: 45505419), protective tool boot.

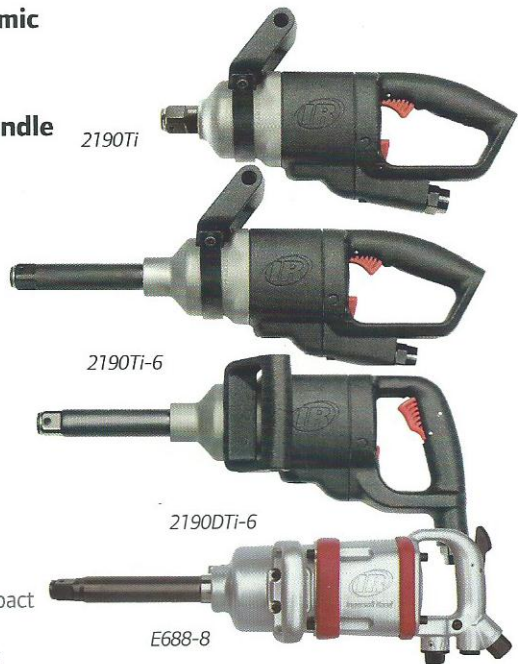

E688-8 - 200mm anvil

- 3800Nm
- pinless single swinging-hammer impact mechanism
- Designed for vehicle service market

Specifications at 6.2 bar (90 psi)

	Nm	Max Nm	1 min. rpm	1 min.	kg	L	AIR NPTF	AIR mm	L/s	Max L/s	dB(A)	m/s ² / K ⁽¹⁾
1" ■												
631L	271-3 390	4 300	3 500	700	16.6	624	1/2"	13	7.1	26.4	108.4	12.7 / 2.5
2190Ti	204-1 356	2 237	6 800	875	6.13	393	1/2"	13	5.6	27.4	103.8	10.4 / 1.5
2190Ti-6	204-1 356	2 237	6 800	875	7.04	522	1/2"	13	5.6	27.4	103.8	12.7 / 2.9
2190DTi-6	204-1 356	2 237	6 800	875	7.26	475	1/2"	13	5.6	27.4	103.8	8.7 / 2.1
280	203-1 356	2 169	6 000	750	9.98	330	1/2"	13	4.7	26.0	109.1	24.1 / 3.4
280-6	203-1 356	2 169	6 000	750	10.8	470	1/2"	13	4.7	26.0	109.1	21.8 / 3.8
285B	136-1 220	2 400 ⁽²⁾	5 000	700	11.2	360	1/2"	13	4.7	17.5	99.8	8.0 / 1.2
285B-6	136-1 220	2 400 ⁽²⁾	5 000	700	12.6	519	1/2"	13	4.7	17.5	99.8	9.0 / 2.7
E688-8	271-3 500	3 800	4 600	-	16.5	630	1/2"	13	9.3	34	103.2	-

(1) ISO28927 – 3-axis measurement: vibration level / measurement uncertainty — (2) at 8.3 bar (120 psi).

Service Kits

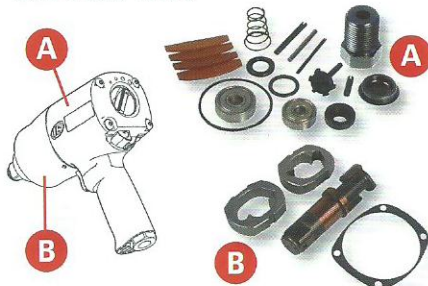

	A	B
631L	631L-TK1A	-
2190Ti	2190-TK1	2190-THK1
2190Ti-6	2190-TK1	2190-6-THK1
2190DTi-6	2190-TK1	2190-6-THK1
280-EU	280-TK2	-
280-6-EU	280-TK2	-
285B	285B-TK1	-
285B-6/285B-6-AP	285B-TK1	-



SK8M4L (CPN: 81287419): 1" socket set. Contains 4 extended sockets (27, 30, 32 and 33 mm).